

# Turning PE collars for valves

The dimensions are minimum; collars can normally be turned to nominal diameters.

PE collars for butterfly valves must be turned when the internal diameter of the collar is less than the minimum dimensions of the butterfly valve. The figures below in column D are recommended minimum measurements.

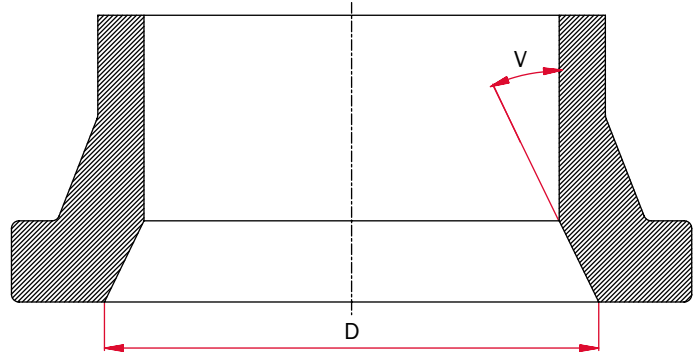

Nominal Diameter	D (min)	Tolerance	V° (angle in degrees)
DN 40	38	2.5	56
DN 50	47	3.5	59
DN 65	62	3.2	45
DN 80	77	2.6	35
DN 100	97	2.7	31
DN 125	123	2.5	27
DN 150	148	2.0	22
DN 200	198	1.7	17
DN 250	248	1.8	16
DN 300	298	2.0	15
DN 350	348	1.6	13
DN 400	397	2.7	15
DN 450	447	3.1	15
DN 500	497	3.5	15
DN 600	596	4.4	15
DN 700	696	4.3	14
DN 800	795	5.1	14
DN 900	895	5.2	13
DN 1000	995	5.3	12
DN 1100	1095	4.8	11
DN 1200	1194	6.1	12
DN 1400	1394	6.4	12
DN 1600	1593	7.3	11

All dimensions in mm